



NORDHAVN  86



Saloon



Galley



Master Stateroom

Following the unparalleled success of the Nordhavn 76 with its sophisticated systems and construction features, PAE's design, engineering and manufacturing team was ready for a larger vessel and at 86 feet, this Nordhavn represents PAE's firm entry into the megayacht market. With a 24-foot beam, she is more than impressive at first sight, however her full load displacement of over 400,000 pounds allows her to compare with many vessels well over 100 feet.

Building on the experience of hundreds of thousands of ocean crossing miles and applying the "form follows function" rule, this ultimate offshore passagemaker has been designed in an aft wheelhouse configuration. For comfort and visibility at sea, this arrangement cannot be beat and with her long foredeck, tenders up to 20 feet can be accommodated.

There is no question the Nordhavn 86 is a large yacht. The first impressions from the outside are of great mass and powerful lines, but it's the interior volume that has to be experienced to be appreciated.

Taking advantage of the enormous capacity of this hull, the new Nordhavn 86 offers accommodations that are nothing short of remarkable. The saloon and galley measures 36 feet in length, the master cabin and head are full width consuming the whole forward/upper section of the vessel and the combination of wheelhouse, captain's cabin and sky lounge measure almost 30 feet in length. In addition to the master stateroom and captain's cabin, the vessel includes three guest staterooms with ensuite heads and an additional crew cabin and head aft with an interior and exterior entrance. A laundry and utility room are also provided. The luxurious and functional interior is finished with fine hardwoods, beautiful moldings and raised panels combined with stone floors, granite countertops, the finest hardware, lighting and fixtures.

The Nordhavn 86 is designed for customization, and most owners elect to engage professional interior designers. Some suggest alterations to layout, but all use furnishings, textures and colors to imprint owners' personalities and tastes. Thus, each of the yachts launched to date is, effectively, unique. Finishing choices also result in interiors with remarkably different appearances and "feel".

Construction of the N86 is conventional fiberglass, built to extremely heavy scantlings using beautifully constructed female molds for the entire hull and deck. Starting with a seamless, flawless structure, a highly detailed gelcoated finish possible only with this molding process, she will then receive a complete Alexseal paint job prior to assembly. A combination of the highly detailed molding and the superior luster and maintainability of the Alexseal paint will result in a yacht finish that is to the highest possible standard. Designed and built to the latest international standards, each new Nordhavn 86 can be built to ABS certification with +A1 Yachting Service rating for the hull and AMS rating for machinery and installation as an option.

With all the discussion of the N86's enormity, she presents the ideal juxtaposition: her beamy interior offers the sense of being on a much larger boat yet she handles like a much smaller one.

Twin MTU Series 60 engines rated at 600 hp each spinning 48-inch propellers through 4.59 to 1 reduction gears allow a transatlantic cruising speed of 10 knots. With over 7,000 gallons of fuel aboard and throttled back to the 9 knot range, this new design can run roughly 4,000 miles before refueling. This twin configuration includes integral skegs and two large attached rudders for maximum directional control and propellers that are protected within their own apertures. The advanced high-pressure, common rail, electronically injected engines are fitted with wet exhaust, commercial rated transmissions with large reduction gears and offer efficiency and reliability never before possible.

An extensive list of standard machinery details includes central hydraulics with 20-square-foot stabilizers, 50 hp bow and stern thrusters, hydraulic bilge pumping and anchor wash downs, dual Onan generators, a universal AC electrical system for world wide use, 3,500 lb. Marquipt davit, chilled water air-conditioning system, 2000 gallons per day water maker, automatic engine room and lazarette fire system with ventilation dampeners, an on-deck Jacuzzi and much more. There's little to add to the Nordhavn 86 except electronics and tenders.



Pilothouse



Engine Room



Flybridge

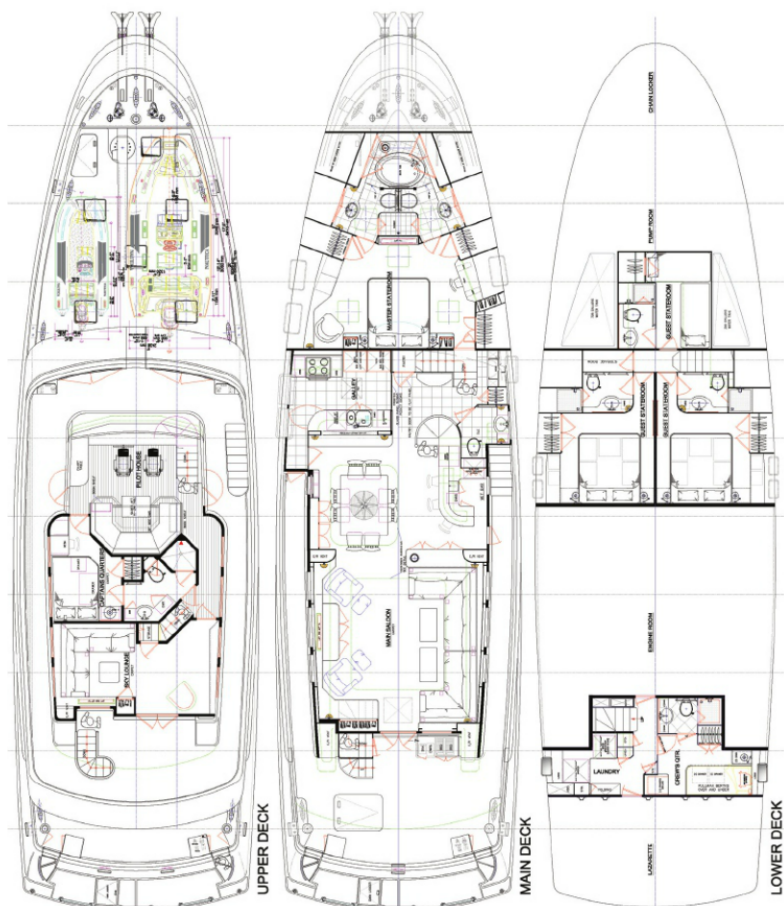

Specifications:

LOA:
86' 7" / 26.39 M

FLYBRIDGE:
Standard

LWL:
77' 11" / 23.75 M

BUILDER:
South Coast, China

BEAM:
24' 0" / 7.32 M

DRAFT:
8' 2" / 2.49 M (full load)

AIR DRAFT:
42' / 12.80 M

DISPLACEMENT:
400,000 lbs. / 181.44 MT (full load)

ENGINE:
MTU Series 60 600 hp (twin)

WATER CAPACITY:
900 US gals. / 3,407 L

FUEL CAPACITY:
7000 US gals. / 26,498 L

HOLDING TANK:
185 US gals. / 700 L

GRAY WATER TANK:
190 US gals. / 719 L

*Specifications subject to change without notice and at the discretion of designers and builders.
**Dimensions are subject to change with Buyer's selected options and personal effects which may add to displacement and increase both draft and waterline length.



NORDHAVN
POWER • THAT IS • PAE • OCEANS • AFART®



Visit the N86
on Nordhavn.com